

# ULTIME D Patented

## metalfire

### Technical Document

ULTIME D MF 600-75 WHE 1S BBQ

#### Dimensions (mm)

- combustion opening WxH: 636x756
- external WxDxH: 860x619x2061
- fresh air: 2x $\phi 150$
- diameter flue:  $\phi 250$

#### Technical Data

- capacity: 18.8kW
- efficiency capacity: 79.6%
- CO (volume with 13%O<sub>2</sub>): 0.07%
- dust (volume with 13%O<sub>2</sub>): 20mg/m<sup>3</sup>
- weight: 368kg
- Air intake to convection: minimum 360cm<sup>2</sup> (2x $\phi 150$ )
- Air exhaust to convection: minimum 360cm<sup>2</sup> (2x $\phi 150$ )

#### Table: prescribed insulation thickness (mm)

Combustable finishing material					
	A	B	C	D	E
Test report (TC = 0,14 W/mK)	83	NC	98	110	40
Metalfire recommended Promasil 1100L (TC = 0,081 W/mK)	50	NC	60	65	25
Non-combustable finishing material					
non-combustable materials (structural building items EXCLUDED e.g. load bearing walls)	0	0	0	0	0
TC = thermal conductivity NC = non-combustible					

#### First aid and technical support:

- support@metalfire.eu
- +32 (0)9 261 50 57

scale 1:25

www.metalfire.eu

EN 13229

General dimensional tolerances up to 6mm  
Metalfire preserves the right to modify specifications without previous notice

Rev.

CE

Sheet  
1/5

Without finishing frame

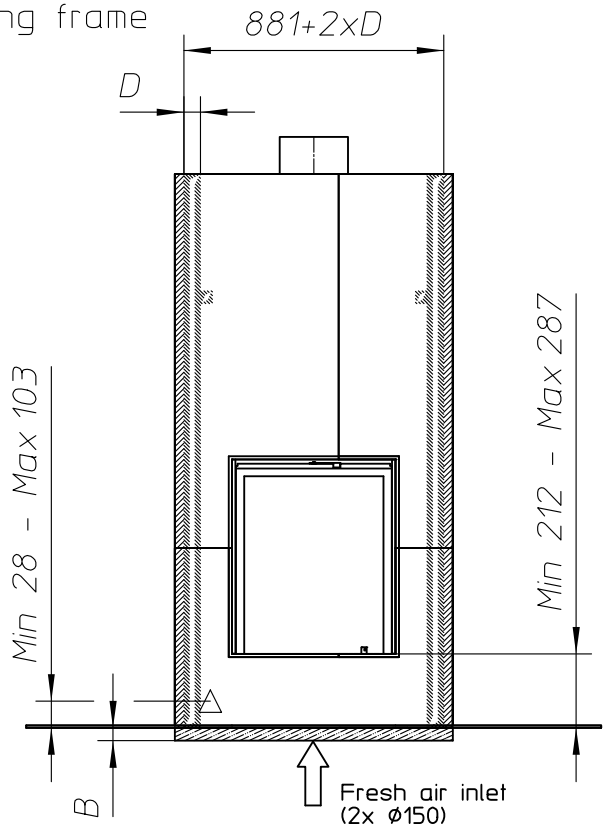

Alternative fresh air inlet (2x Ø150)

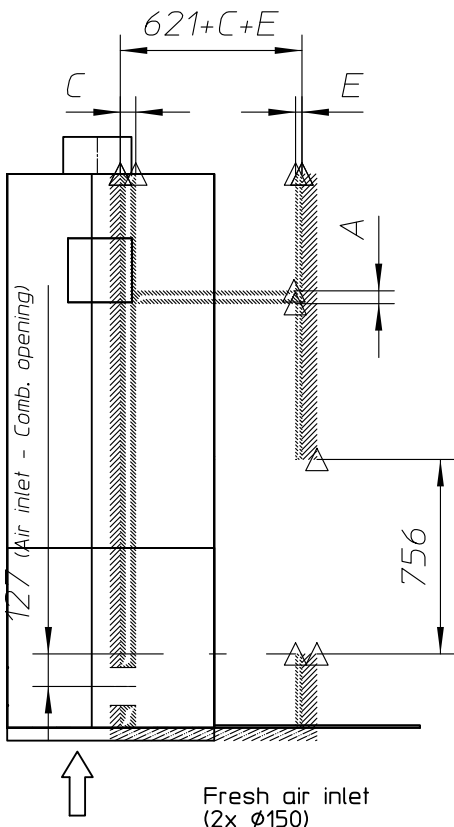

Fresh air inlet (2x Ø150)

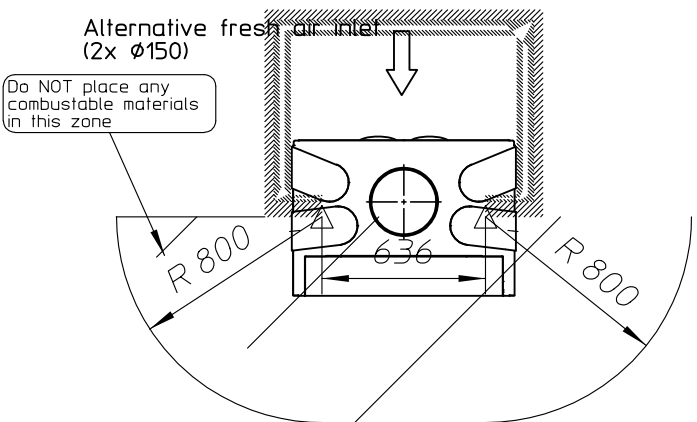

Heated convection air

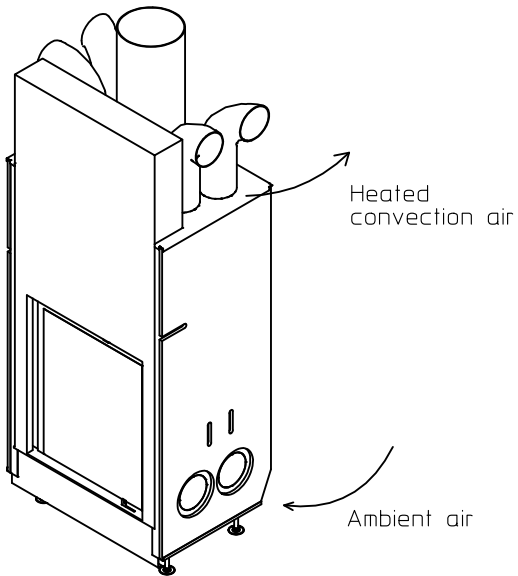

Heated convection air

Ambient air

ULTIME D Patented

metalfire

Technical Document

ULTIME D MF 600-75 WHE 1S BBQ

- Dimensions (mm)**
- combustion opening WxH: 636x756
  - external WxDxH: 860x619x2061
  - fresh air: 2xØ150
  - diameter flue: Ø250

- Technical Data**
- capacity: 18.8kW
  - efficiency capacity: 79.6%
  - CO (volume with 13%O<sub>2</sub>): 0.07%
  - dust (volume with 13%O<sub>2</sub>): 20mg/N<sup>3</sup>
  - weight: 368kg
  - Air intake to convection: minimum 360cm<sup>2</sup> (2xØ150)
  - Air exhaust to convection: minimum 360cm<sup>2</sup> (2xØ150)

- Specifications**
- inside finishing: heat-resistant black paint
  - vermiculite insulation plates
  - convection jacket in galvanized steel
  - cast iron stoke grate
  - back and sides: ribbed cast iron
  - interior finishing: ORIGINAL (ribbed cast iron)

- Options**
- Promat insulation kit
  - Finishing frame

Table: prescribed insulation thickness (mm)

Combustable finishing material					
	A	B	C	D	E
Test report (TC = 0,14 W/mK)	83	NC	98	110	40
Metalfire recommended Promasil 1100L (TC = 0,081 W/mK)	50	NC	60	65	25
Non-combustable finishing material					
non-combustable materials (structural building items EXCLUDED e.g. load bearing walls)	0	0	0	0	0
TC = thermal conductivity NC = non-combustable					

**First aid and technical support:**

- support@metalfire.eu
- +32 (0)9 261 50 57

Combustable finishing material  
Non-combustable finishing material  
Insulation  
Insulation thickness => see table

With finishing frame 90/10

$881+2 \times D$

$D$

Min 28 - Max 78

Detail3  
Scale 1:10

2.38

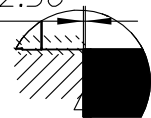

Alternative fresh air inlet  
(2x  $\phi 150$ )



Heated convection air

Do NOT place any  
combustable materials  
in this zone

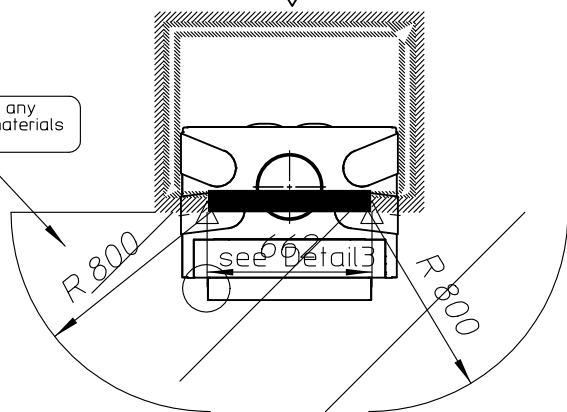

Combustable finishing material  
 Non-combustable finishing material  
 Insulation  
 Insulation thickness => see table

Alternative fresh air inlet  
(2x  $\phi 150$ )

102 (Air inlet - Comb. opening)

$621+C+E$

$C$

$E$

$A$

75.95

782

Fresh air inlet  
(2x  $\phi 150$ )

Heated  
convection air

Ambient air

ULTIME D Patented

metalfire

## Technical Document

ULTIME D MF 600-75 WHE 1S BBO

### Dimensions (mm)

- combustion opening WxH: 636x756
- external WxDxH: 860x619x2061
- fresh air: 2x $\phi 150$
- diameter flue:  $\phi 250$

### Technical Data

- capacity: 18.8kW
- efficiency capacity: 79.6%
- CO (volume with 13%O<sub>2</sub>): 0.07%
- dust (volume with 13%O<sub>2</sub>): 20mg/m<sup>3</sup>
- weight: 368kg
- Air intake to convection: minimum 360cm<sup>2</sup> (2x $\phi 150$ )
- Air exhaust to convection: minimum 360cm<sup>2</sup> (2x $\phi 150$ )

### Specifications

- inside finishing: heat-resistant black paint
- vermiculite insulation plates
- convection jacket in galvanized steel
- cast iron stoke grate
- back and sides: ribbed cast iron
- interior finishing: ORIGINAL (ribbed cast iron)

### Options

- Promat insulation kit
- Finishing frame

### Table: prescribed insulation thickness (mm)

Combustable finishing material					
	A	B	C	D	E
Test report (TC = 0,14 W/mK)	83	NC	98	110	40
Metalfire recommended Promasil 1100L (TC = 0,081 W/mK)	50	NC	60	65	25
Non-combustable finishing material					
non-combustable materials (structural building items EXCLUDED e.g. load bearing walls)	0	0	0	0	0

TC = thermal conductivity NC = non-combustable

### First aid and technical support:

- support@metalfire.eu
- +32 (0)9 261 50 57

scale 1:30

www.metalfire.eu

EN 13229

General dimensional tolerances up to 6mm  
Metalfire preserves the right to modify specifications without previous notice

Rev.

CE

Sheet  
3/5

WITH FIRESCREEN - NO FINISHING FRAME

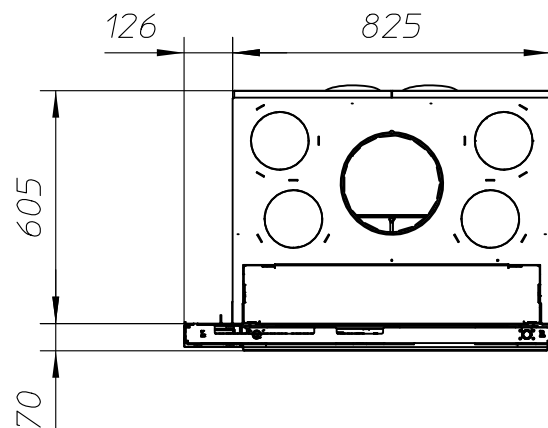
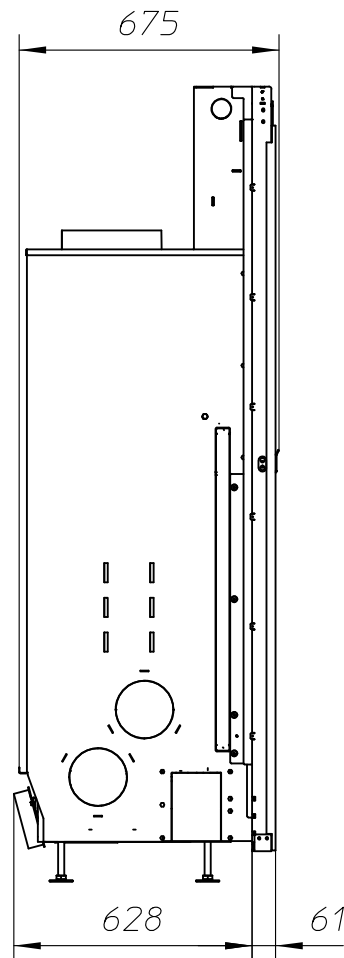
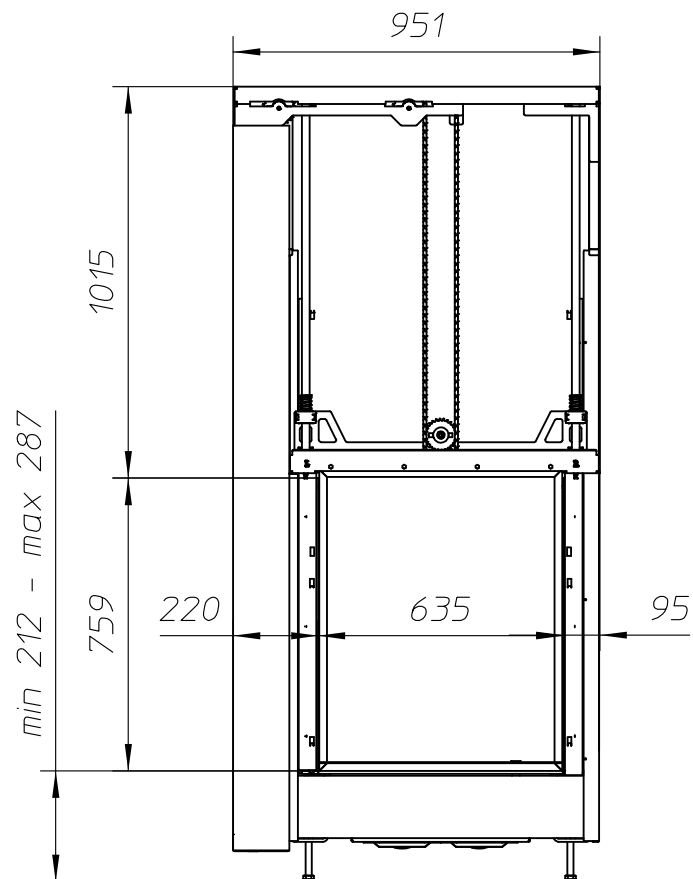

ULTIME D Patented

metalfire

## Technical Document

ULTIME D MF 600-75 WHE 1S BBQ

### Dimensions (mm)

- combustion opening WxH: 636x756
- external WxDxH: 951x675x2061
- fresh air: 2x $\varnothing$ 150
- diameter flue:  $\varnothing$ 250

### Technical Data

- capacity: 18.8kW
- efficiency capacity: 79.6%
- CO (volume with 13%O<sub>2</sub>): 0.07%
- dust (volume with 13%O<sub>2</sub>): 20mg/Nm<sup>3</sup>
- weight: 368kg
- Air intake to convection: minimum 360cm<sup>2</sup> (2x $\varnothing$ 150)
- Air exhaust to convection: minimum 360cm<sup>2</sup> (2x $\varnothing$ 150)

### Specifications

- inside finishing: heat-resistant black paint
- vermiculite insulation plates
- convection jacket in galvanized steel
- cast iron stoke grate
- back and sides: ribbed cast iron
- interior finishing: ORIGINAL (ribbed cast iron)

First aid and technical support:

- support@metalfire.eu
- +32 (0)9 261 50 57

scale 1:20

Rev.

www.metalfire.eu EN 13229

CE

General dimensional tolerances up to 6mm  
Metalfire preserves the right to modify specifications without previous notice

Sheet  
4/5

WITH FIRESCREEN AND FINISHING FRAME 120/10

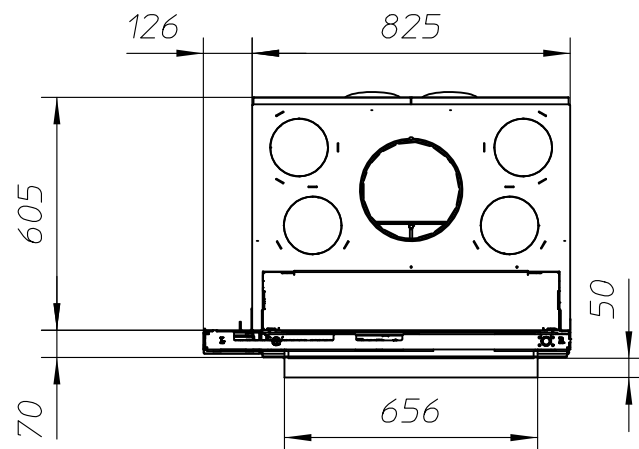
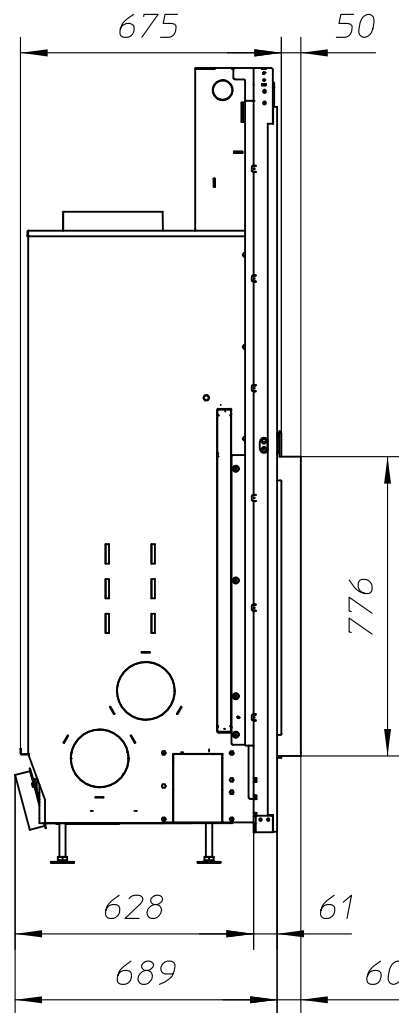
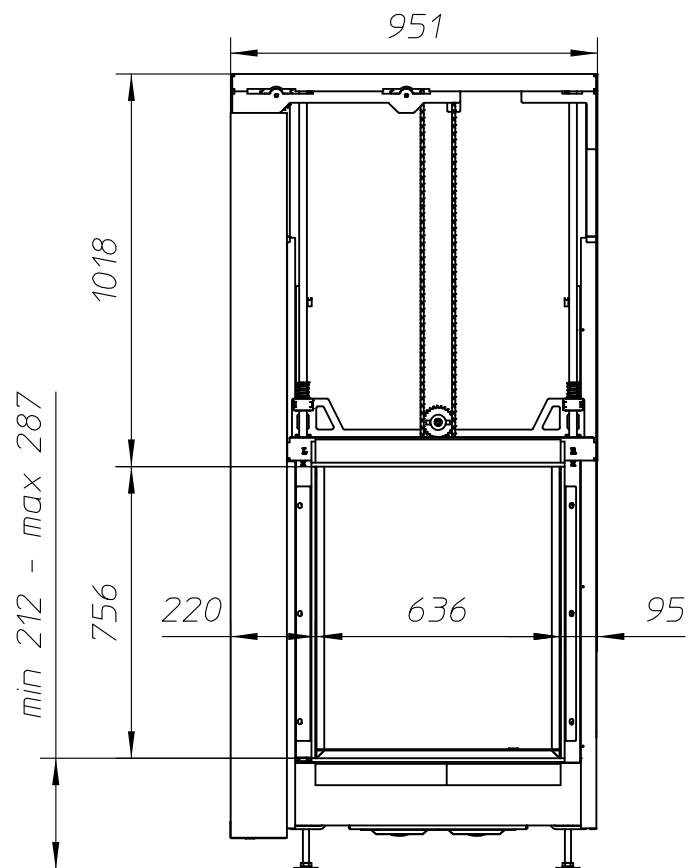

ULTIME D Patented

metalfire

Technical Document

ULTIME D MF 600-75 WHE 1S BBQ

#### Dimensions (mm)

- combustion opening WxH: 636x756
- external WxDxH: 951x749x2061
- fresh air: 2xø150
- diameter flue: ø250

#### Technical Data

- capacity: 18.8kW
- efficiency capacity: 79.6%
- CO (volume with 13%O<sub>2</sub>): 0.07%
- dust (volume with 13%O<sub>2</sub>): 20mg/Nm<sup>3</sup>
- weight: 368kg
- Air intake to convection: minimum 360cm<sup>2</sup> (2xø150)
- Air exhaust to convection: minimum 360cm<sup>2</sup> (2xø150)

#### Specifications

- inside finishing: heat-resistant black paint
- vermiculite insulation plates
- convection jacket in galvanized steel
- cast iron stoke grate
- back and sides: ribbed cast iron
- interior finishing: ORIGINAL (ribbed cast iron)

First aid and technical support:

- support@metalfire.eu
- +32 (0)9 261 50 57

scale 1:20

Rev.

www.metalfire.eu EN 13229

CE

General dimensional tolerances up to 6mm  
Metalfire preserves the right to modify specifications without previous notice

Sheet  
5/5